

Roof tiles on treated battens on Vapour permeable (LR) type to BSEN 13707.

35x75mm or 35x97mm C16 gable ladder with rungs at 600mm centres to be fixed to first truss and skew nailed with 90mm ARS nails to the top of the gable spandrel. 100x25mm c16 batten fixed to top chord of ladder to provide edge fixing for tilers batten.

Standard lateral restraint strap fixed to be fixed to at least 3 trusses and fully supported with noggins. Strap fixed to each truss with 1 No. 30mm square twist nail and to each noggin with 3 equally spaced 30mm square twist nails. Minimum 8 fixings per strap.

Dry verge system

Barge board fixed to rungs in ladder with 2 No. polytop nails

Solid noggins between trusses to be full length of lateral restraint strap.

100mm pvc sleeved fibreglass quilt stop to top of cavity

Staifix -STF6 Timber frame Cavity Wall Tie. Fixed at NHBC approved spacing. Wall tie to be fixed to spandrel studs with ARS nails.

102.5 outer leaf brick

Longitudinal top chord bracing and web bracing fixed to bearers with 90mm ARS nails, site fixed to inside face of spandrel and 45x72mm timber ledger above. Refer to truss layout for position.

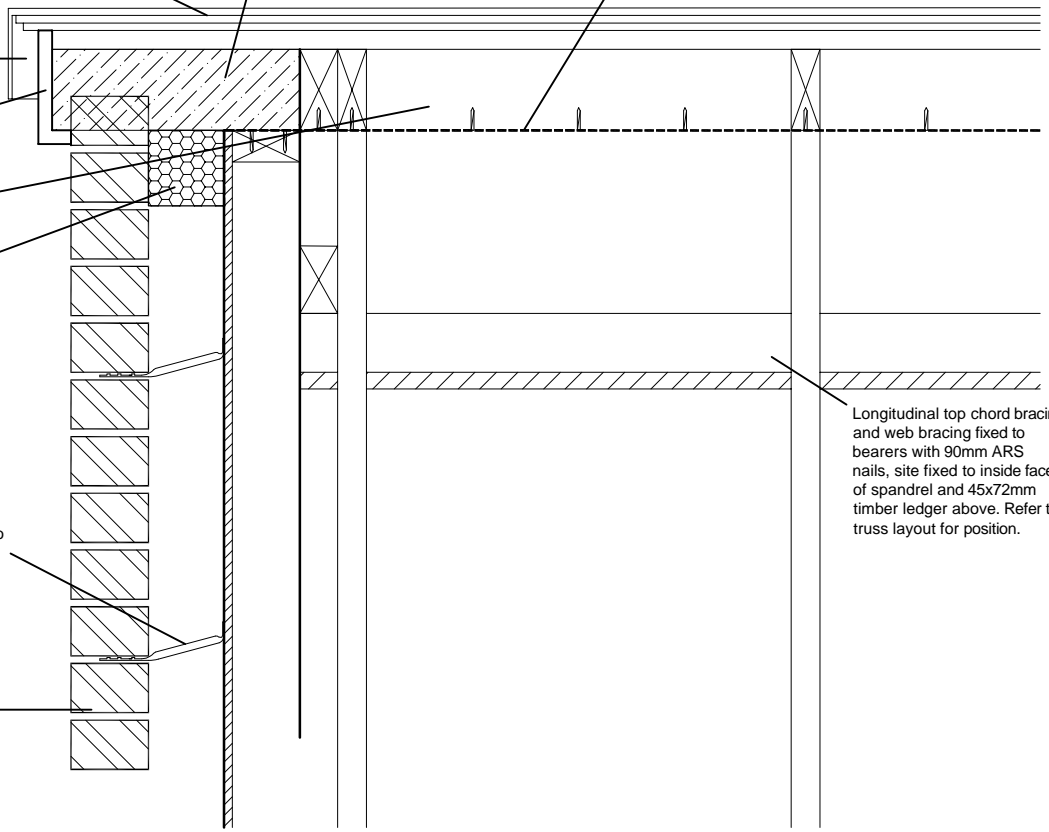

| REV. | DATE. | DESCRIPTION. | BY. |
|------|-------|--------------|-----|
| | | | |

These details have been produced for guidance only. It is the responsibility of the building designer to ensure that the details shown are compatible with the overall building design and will satisfy the relevant parts of the Building Regulations applicable before they are adopted into the project design.



H+H UK Limited
 Technical Services Dept.
 Celcon House
 Ightham, Sevenoaks
 Kent, TN15 9HZ.
 Tel +44 (0)1732 880580
 Email tsd@hhcelcon.co.uk

TITLE Vertical Wall Panel detail
 Gable wall spandrel - Head

DWG No. VED056

DRAWN BY MAB CHECKED BY SJK

DATE 19/7/21 SCALE 1:10 REV.NO. 00

Gable wall spandrel panel - head detail (Clipped verge)